





AGENDA



ABDO CLINICAL CONFERENCE 2025

SUNDAY 12 and MONDAY 13 OCTOBER 2025

NRC | Birmingham
NATIONAL RESOURCE CENTRE

8:45 - 9:15		REGISTRATION
8:45 - 9:15	Exhibition opens VRT with discussion	<div><div>Target groups</div><div><div>Dispensing opticians CPD PROVIDER General Optical Council</div><div>Optometrists CPD PROVIDER General Optical Council</div><div>Contact lens opticians CPD PROVIDER General Optical Council</div></div><div>2 interactive CPD points</div><div> INTERACTIVE</div></div>
9:15 - 9:25		WELCOME from ABDO in the Exhibition Area
9:25 - 10:55	WORKSHOP SESSION Rotation 01 More details available on page 2	<div><div>Target groups</div><div><div>Dispensing opticians CPD PROVIDER General Optical Council</div><div>Optometrists CPD PROVIDER General Optical Council</div><div>Contact lens opticians CPD PROVIDER General Optical Council</div></div><div>3 interactive CPD points</div><div> INTERACTIVE</div></div>
10:55 - 11:15	BREAK: Exhibition / VRT with discussion	
11:15 - 12:45	WORKSHOP SESSION Rotation 02 More details available on page 2	<div><div>Target groups</div><div><div>Dispensing opticians CPD PROVIDER General Optical Council</div><div>Optometrists CPD PROVIDER General Optical Council</div><div>Contact lens opticians CPD PROVIDER General Optical Council</div></div><div>3 interactive CPD points</div><div> INTERACTIVE</div></div>
12:45 - 13:40	LUNCH: Exhibition / VRT with discussion	
13:40 - 15:10	WORKSHOP SESSION Rotation 03 More details available on page 2	<div><div>Target groups</div><div><div>Dispensing opticians CPD PROVIDER General Optical Council</div><div>Optometrists CPD PROVIDER General Optical Council</div><div>Contact lens opticians CPD PROVIDER General Optical Council</div></div><div>3 interactive CPD points</div><div> INTERACTIVE</div></div>
15:10 - 15:30	BREAK: Exhibition / VRT with discussion	
15:30 - 17:00	WORKSHOP SESSION Rotation 04 More details available on page 2	<div><div>Target groups</div><div><div>Dispensing opticians CPD PROVIDER General Optical Council</div><div>Optometrists CPD PROVIDER General Optical Council</div><div>Contact lens opticians CPD PROVIDER General Optical Council</div></div><div>3 interactive CPD points</div><div> INTERACTIVE</div></div>
17:00	CONFERENCE CLOSES	

GROUP ROTATIONS



ABDO CLINICAL CONFERENCE 2025

SUNDAY 12 and MONDAY 13 OCTOBER 2025

NRC | Birmingham

NATIONAL RESOURCE CENTRE

9:25	GROUP A - Rotation 1 Dry eye on the front line 5th FLOOR	GROUP B - Rotation 1 Escape the circle of dry eye disease 4th FLOOR Exhibition Area	GROUP C - Rotation 1 Supporting a dry eye clinic 4th FLOOR Sclera and Retina rooms	GROUP D - Rotation 1 Dry Eye Puzzle: Diagnostic Strategies from TFOS DEWS III 4th FLOOR - Iris room
11:15	GROUP A - Rotation 2 Dry Eye Puzzle: Diagnostic Strategies from TFOS DEWS III 4th FLOOR - Iris room	GROUP B - Rotation 2 Dry eye on the front line 5th FLOOR	GROUP C - Rotation 2 Escape the circle of dry eye disease 4th FLOOR Exhibition Area	GROUP D - Rotation 2 Supporting a dry eye clinic 4th FLOOR Sclera and Retina rooms
13:40	GROUP A - Rotation 3 Supporting a dry eye clinic 4th FLOOR Sclera and Retina rooms	GROUP B - Rotation 3 Dry Eye Puzzle: Diagnostic Strategies from TFOS DEWS III 4th FLOOR - Iris room	GROUP C - Rotation 3 Dry eye on the front line 5th FLOOR	GROUP D - Rotation 3 Escape the circle of dry eye disease 4th FLOOR Exhibition Area
15:30	GROUP A - Rotation 4 Escape the circle of dry eye disease 4th FLOOR Exhibition Area	GROUP B - Rotation 4 Supporting a dry eye clinic 4th FLOOR Sclera and Retina rooms	GROUP C - Rotation 4 Dry Eye Puzzle: Diagnostic Strategies from TFOS DEWS III 4th FLOOR - Iris room	GROUP D - Rotation 4 Dry eye on the front line 5th FLOOR

Dry eye on the front line

In this workshop you will encounter three patients who are all presenting with potential dry eye concerns. You will work in teams with your peers to analyse the provided information, pose questions to the patients and formulate appropriate next steps whilst considering the multi-disciplinary eyecare team in your practice.

Escape the circle of dry eye disease

Often described as a vicious circle, dry eye disease can seriously impact the lives of our patients. In this interactive educational escape room set in the conference exhibition, you will work in a team of your peers to better understand how patients can be supported with diagnosis and management of dry eye and escape the dry eye circle with them.

Dry Eye Puzzle: Diagnostic Strategies from TFOS DEWS III

This discussion workshop explores the individual roles and scope of practice eyecare practitioners play in the identification and management of dry eye disease (DED). The use of dry eye symptom questionnaires in practice, particularly their effectiveness in capturing patient reported symptoms including the OSDI-6 questionnaire recommended by the TFOS DEWS III Diagnostic Methodology Report. DED diagnostic challenges, early detection of risk and record keeping will also be discussed.

Supporting a dry eye clinic

This practical session introduces key skills for understanding, using, and teaching the application of ocular lubricants and adjunct therapies as part of dry eye clinic. The session is divided into interactive stations to help build both clinical confidence and patient education strategies.

WORKSHOP LOCATIONS



ABDO CLINICAL CONFERENCE 2025

SUNDAY 12 and MONDAY 13 OCTOBER 2025

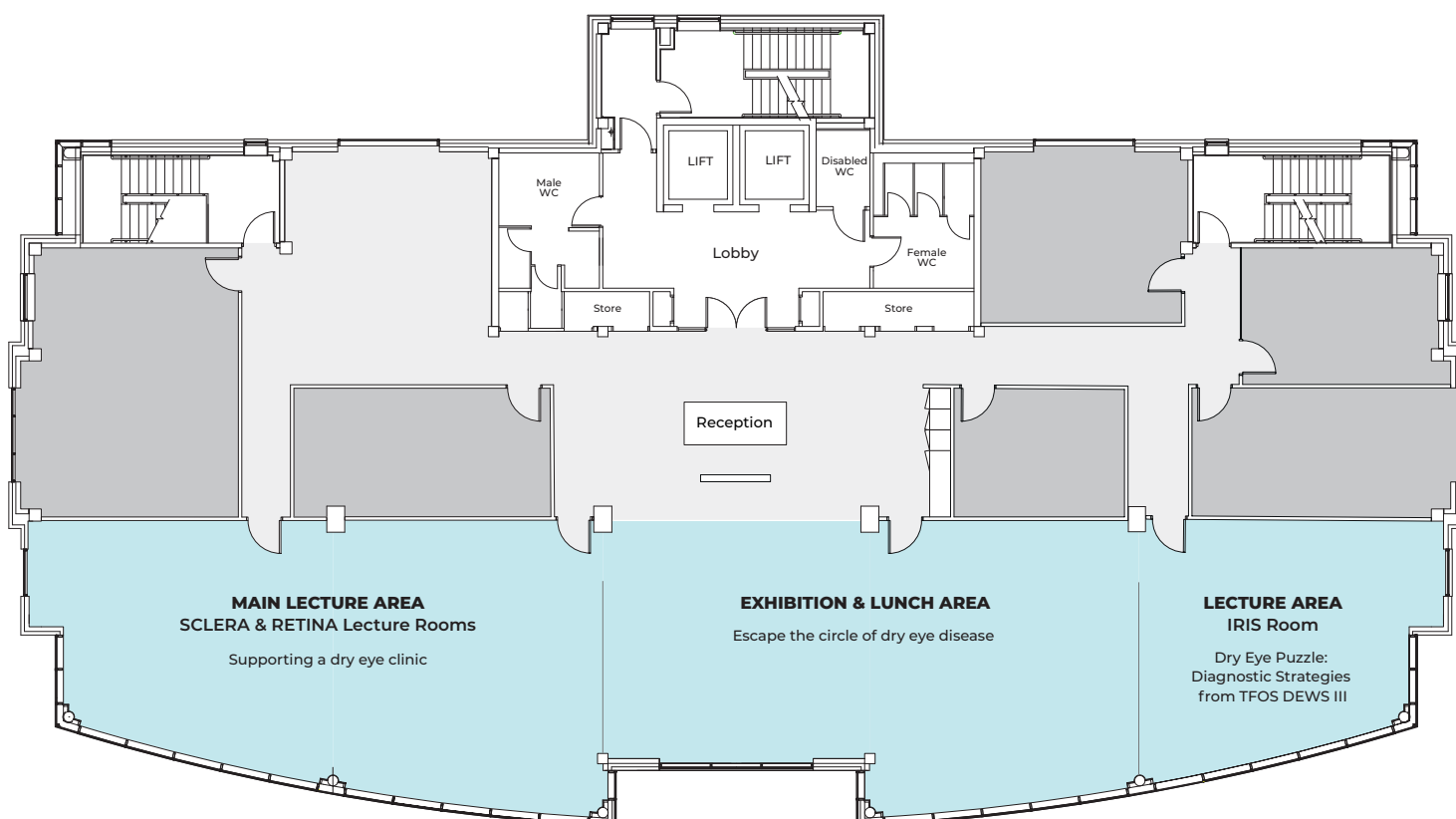

FOURTH FLOOR

NRC | Birmingham
NATIONAL RESOURCE CENTRE

WORKSHOP LOCATIONS



ABDO CLINICAL CONFERENCE 2025

SUNDAY 12 and MONDAY 13 OCTOBER 2025

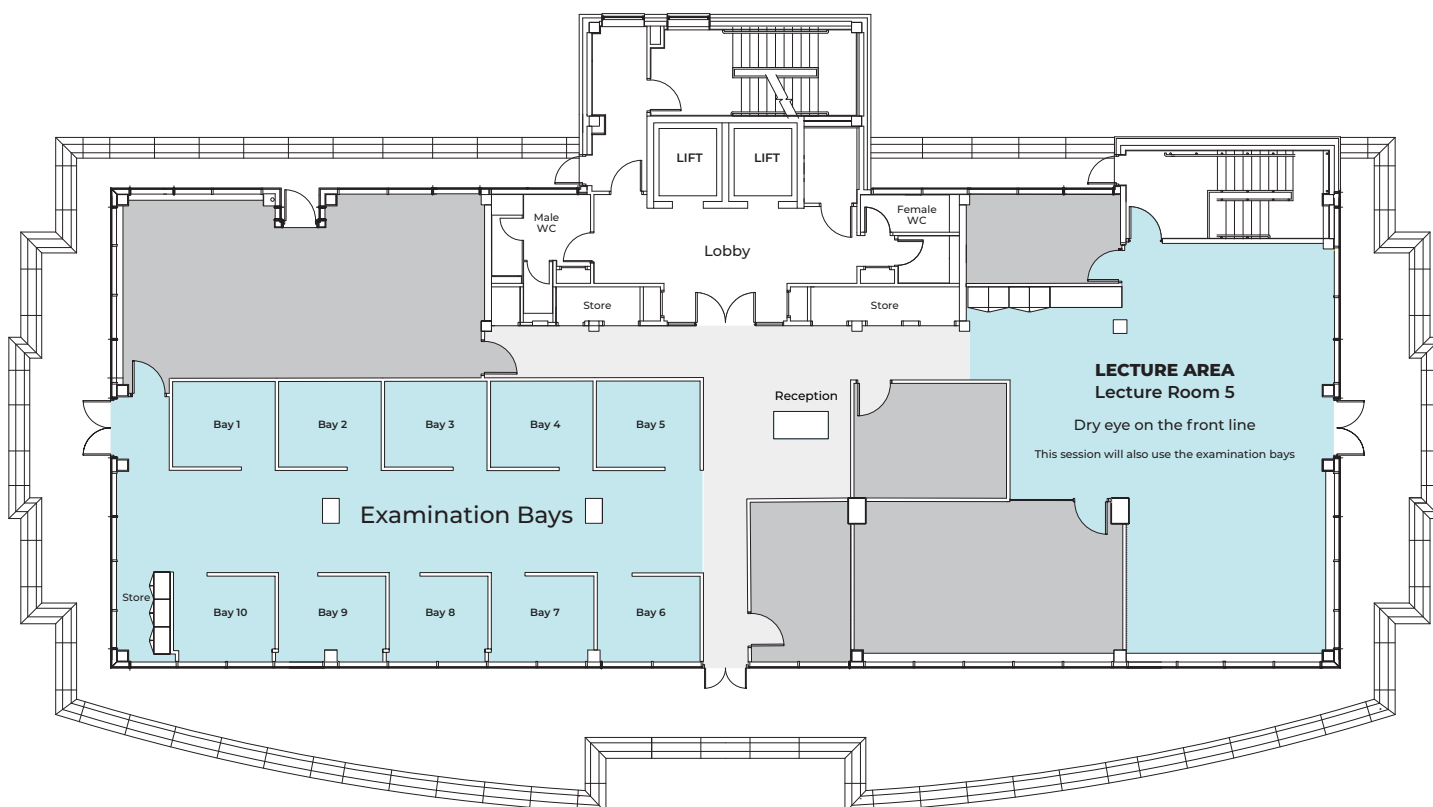

FIFTH FLOOR

NRC | Birmingham
NATIONAL RESOURCE CENTRE